

REVISIONS				
ZONE	REV.	DESCRIPTION	DATE	APPROVED
	2	MANY LITTLE MODS, COOL GRAY COLOR		
	6	Go from 2 to 4 feet per half, larger flat washer, small 4-40 nut to larger 4-40 nut. Now 35.6grams. gsw 11/19/07		
	7	Add chisel to end of feet, add strengtheners near nylon tie return, Now weighs 36.27 grams, 1/24/08		
	8	Added backplate, Now weighs 40.51 grams, 3/11/08		
	9	moved 37mils closer to i4xx card, made easier to insert front panel so less likely to spread there, 10/3/08		

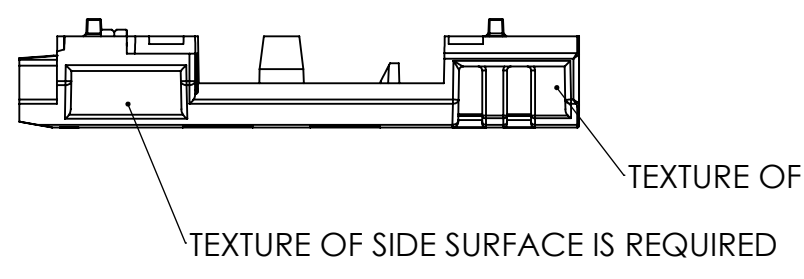
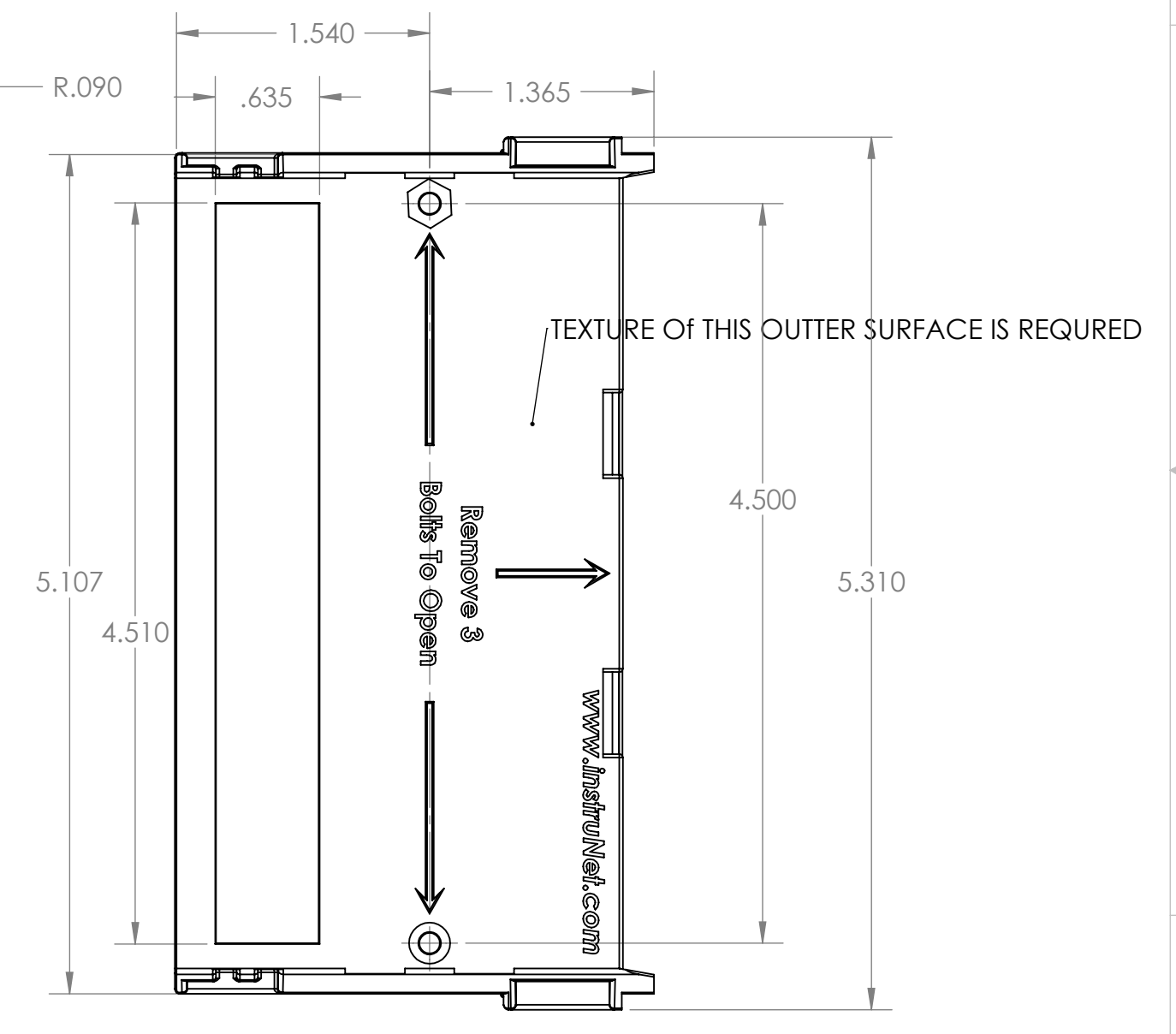
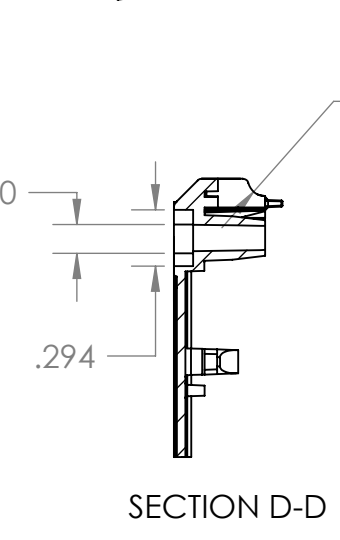
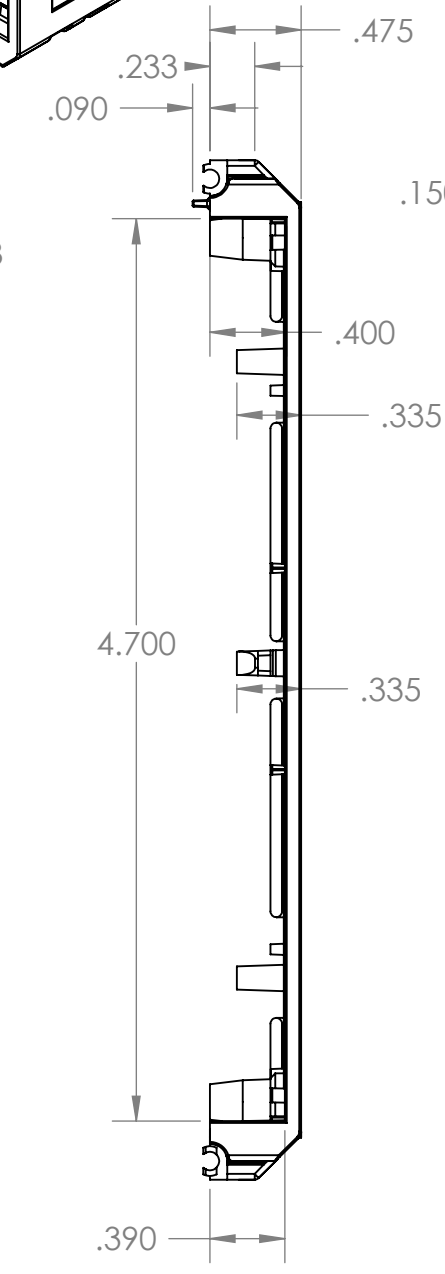
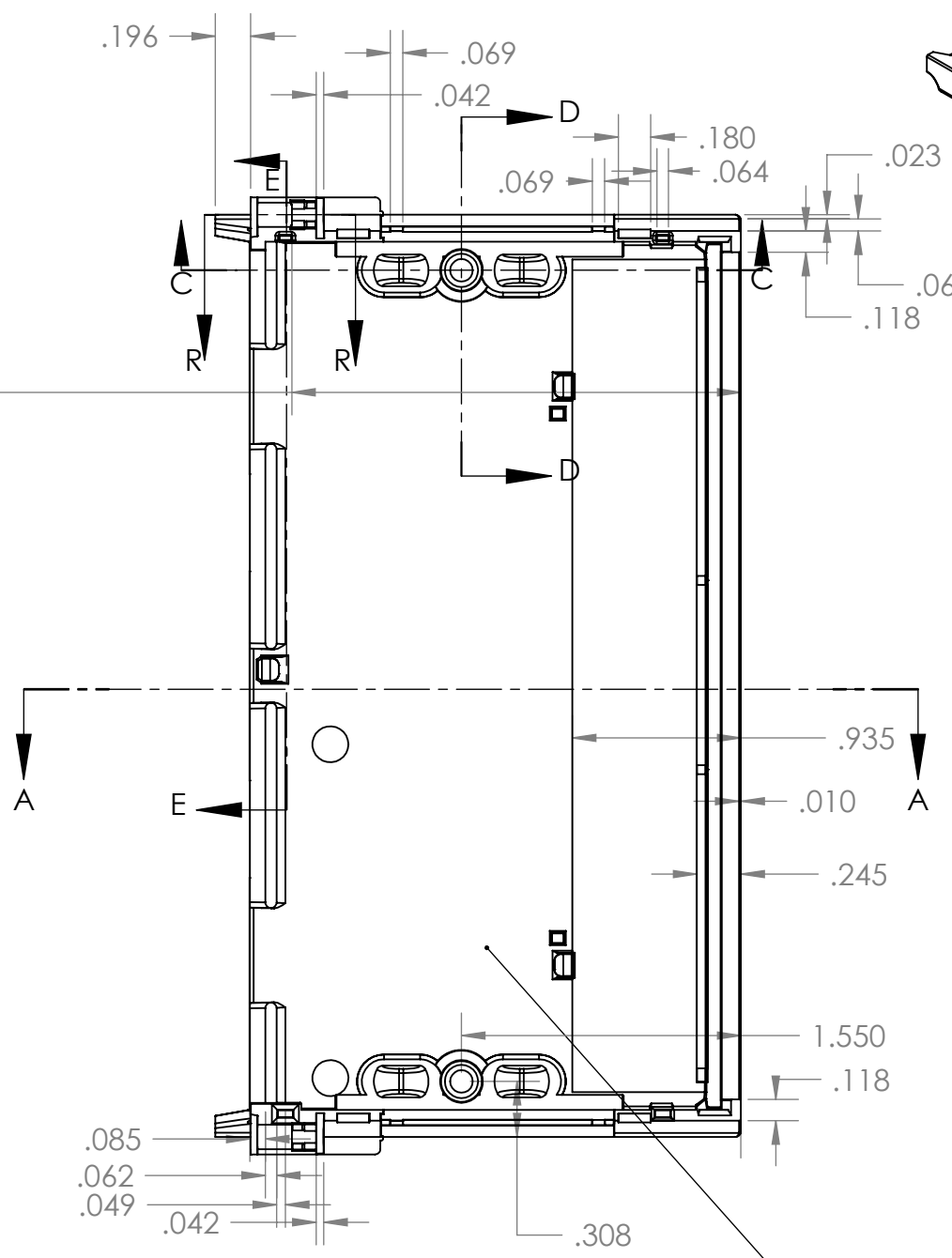
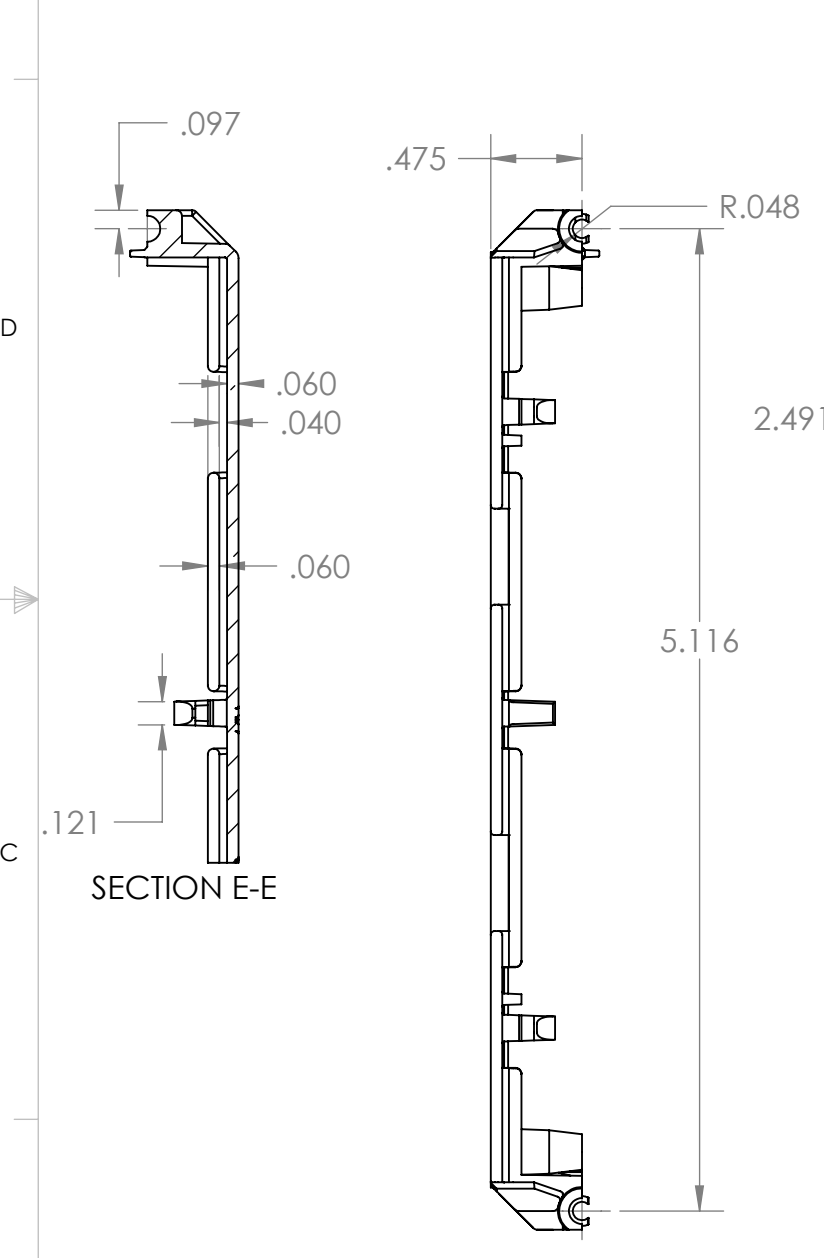
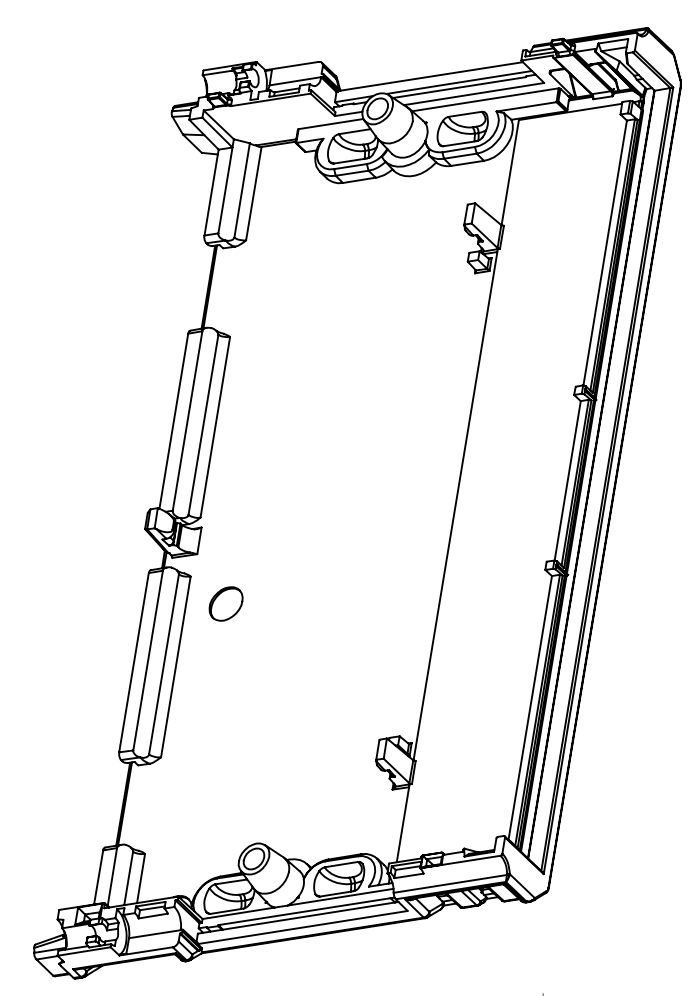
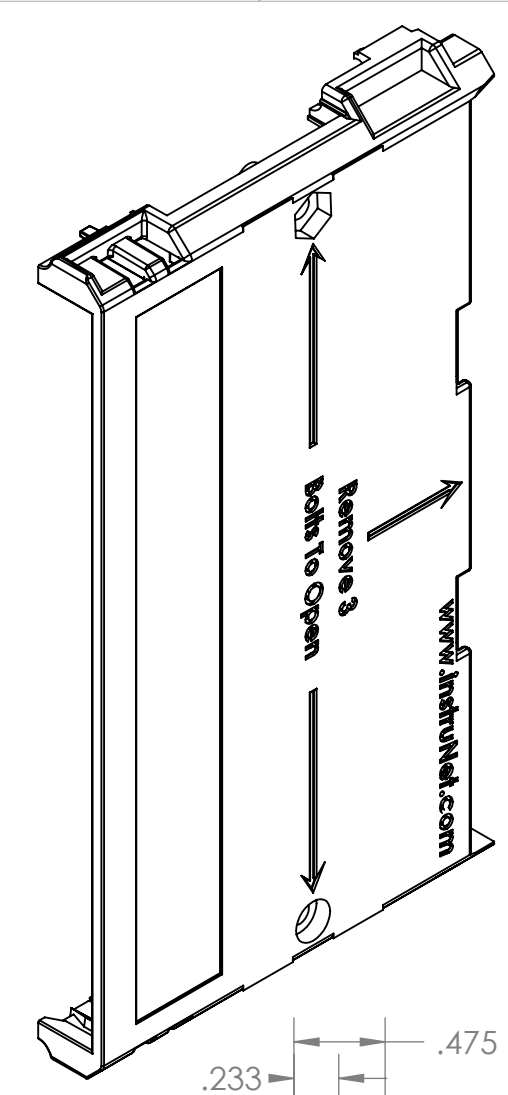
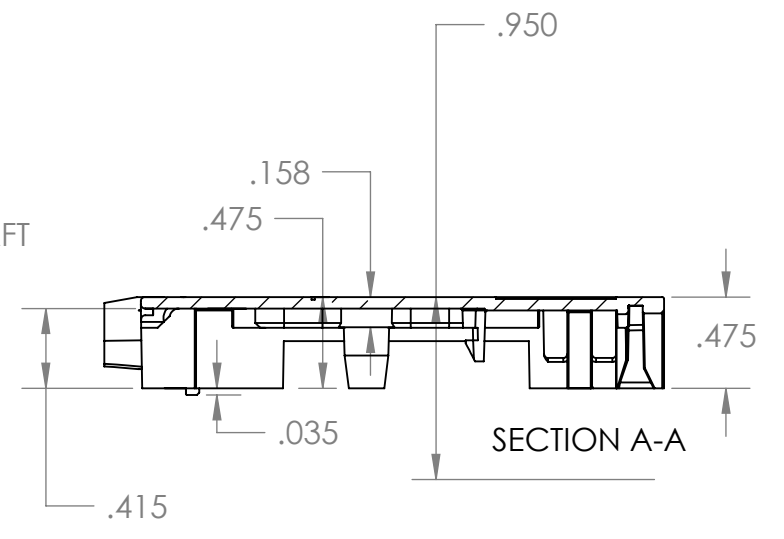
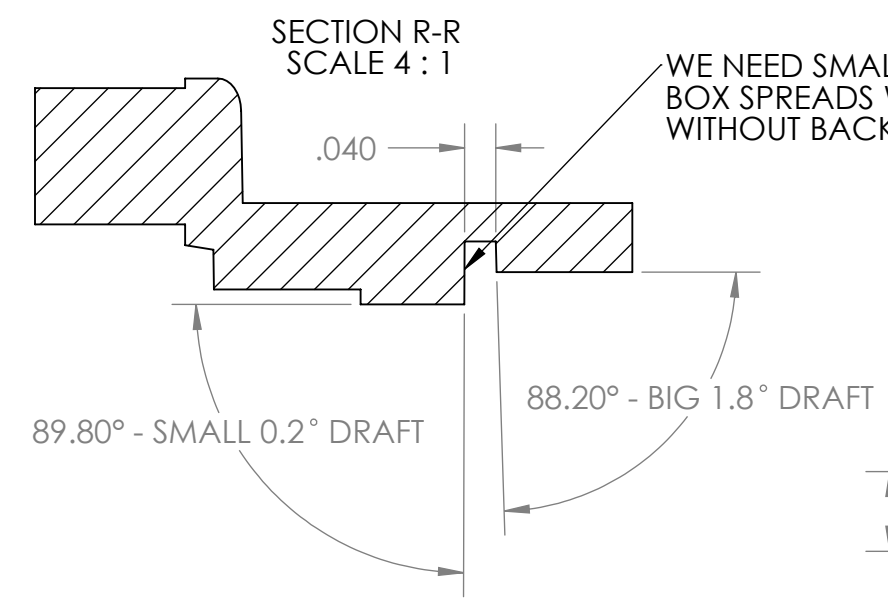

- NOTES:
- MAT'L: VIRGIN ABS PLASTIC, FLAME RETARDANT, RoHS COMPLIANT
 - TEXTURE: MT1055-5 TEXTURE
 - COLOR: LIGHT BLUE, PANTONE PMS 279C (25% REFLEX BLUE, 75% TRANS. WHITE)
 - PACK SO THEY DONT SCRATCH

PROPRIETARY AND CONFIDENTIAL
 THE INFORMATION CONTAINED IN THIS DRAWING IS THE SOLE PROPERTY OF GW INSTRUMENTS. ANY REPRODUCTION IN PART OR AS A WHOLE WITHOUT THE WRITTEN PERMISSION OF GW INSTRUMENTS IS PROHIBITED. COPYRIGHT gwi 2004

UNLESS OTHERWISE SPECIFIED:		NAME	DATE	www.instruNet.com	
DIMENSIONS ARE IN INCHES		DRAWN	JDM		10/04
TOLERANCES:		CHECKED			
FRACTIONAL ±		ENG APPR.			
ANGULAR: MACH ± 1° BEND ±		MFG APPR.			
TWO PLACE DECIMAL ± .01		Q.A.			
THREE PLACE DECIMAL ± .005		COMMENTS:			
INTERPRET GEOMETRIC TOLERANCING PER:					
MATERIAL					
FINISH					
NEXT ASSY	USED ON				
APPLICATION		DO NOT SCALE DRAWING			
SIZE	DWG. NO.	REV			
C		9			
SCALE: 1:1	WEIGHT:	SHEET 1 OF 1			